

DIN 910 - Hexagon Head Screw Plugs

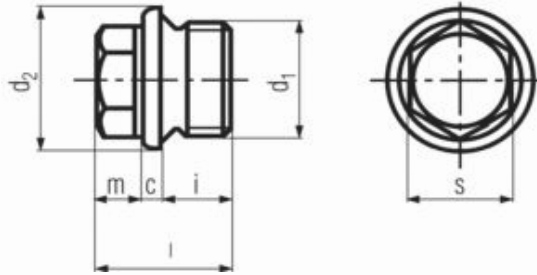

All measurements in millimeters (mm)

d_1	d_2	s	c	i	l approx	m approx
M10 x 1	14	10	3	8	17	6
M12 x 1.5	17	13	3	12	21	6
M14 x 1.5	19	13	3	12	21	6
M16 x 1.5	21	17	3	12	21	6
M18 x 1.5	23	17	4	12	24	8
M20 x 1.5	25	19	4	14	26	8
M22 x 1.5	27	19	4	14	26	8
M24 x 1.5	29	22	4	14	27	9
M26 x 1.5	31	24	4	16	30	10
M27 x 2	32	24	4	16	30	10
M30 x 1.5	36	24	4	16	30	10
M33 x 2	39	27	5	16	32	11
M36 x 1.5	42	27	5	16	32	11
M38 x 1.5	44	27	5	16	32	11
M42 x 1.5	49	30	5	16	33	12
M45 x 1.5	52	30	5	16	33	12
M48 x 1.5	55	30	5	16	33	12
M52 x 1.5	60	30	5	16	33	12
M56 x 2	64	36	5	20	40	15
M64 x 2	72	36	5	20	40	15

FOR INFORMATION PURPOSES ONLY

©Fastener Network Holdings Ltd, Unit B, Grazebrook Industrial Park, Peartree Lane, Dudley, West Midlands, DY2 0XW, United Kingdom

T: +44 (0) 1384 217 600 F: +44 (0) 1384 217 606

www.fastenernetwork.co.uk